

Installation Engineers Contact Details:				Luminaire Ref / Location							
Name:		Tel:									
Luminaire Details:				Full Recharge Duration 24Hours		Duration: 3 Hours		Lamp Type: LED			
ROUTINE TEST RECORD											
Test Type	Year 1		Year 2		Year 3		Year 4		Year 5		
	Signed	Date	Signed	Date	Signed	Date	Signed	Date	Signed	Date	
Functional											
Functional											
Functional											
Functional											
Functional											
Functional											
Functional											
Functional											
Functional											
Functional											
Functional											
3hr Duration											

### Dimensions:

Part No.	Description	L (mm)	W (mm)	H (mm)	Weight
430950	Darwell Emergency Bulkhead	350	110	64	0.35Kg

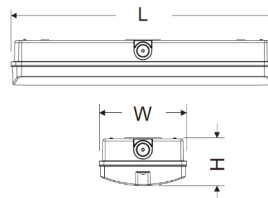

### End Of Life Disposal:

Disassembly instructions for end of life disposal available on website.  
 Disposal of Electronic Equipment WEEE Directive 2002/96/EC This product falls within the scope of the Waste Electrical & Electronic Equipment Directive (WEEE), which means the product should not be disposed of as normal household waste. Please recycle where facilities exist or check with your Local Authority. RoHS – All components and materials used in this product are RoHS 2002/95/EC compliant. Specifications may change from time to time. The information contained in this leaflet is for guidance only and should not be considered as always accurate and should be treated as not representative.

## Installation Instructions



## Darwell Emergency Bulkhead



Input	220-240V 50/60Hz
Power	4W
Operating Temp	0-30°C
Battery	3.2V LiFePO4 1500mAh
Recharge Time	24Hrs
Function	Self-Test / Manual Test
Light Source Energy Rating	N/A



### Box Contents:

- Emergency Bulkhead
- Fixing Kit
- Legend Kit



Selectable  
Emergency



Professionally  
Replaceable



Professionally  
Replaceable



Loop In  
Loop Out



Class II



Ingress  
Protection

### Tools Required For Installation:

- Drill
- Wire Cutter / Strippers
- Screwdriver



Scan for more



**READ THESE INSTRUCTIONS THOROUGHLY BEFORE INSTALLATION**  
**KEEP THESE INSTRUCTIONS FOR FUTURE REFERENCE.**

### IMPORTANT:

This product must be installed by a qualified electrician or competent person, and in accordance with current building and IET wiring regulations.

### Warranty:

This luminaire is warranted for a period of 5 years from the date of purchase\*\*. The backup battery pack in the emergency version is warranted for a period of 5 Years. The warranty could be invalidated should the light fitting not be installed according to these instructions, outside the scope of the specification or the product has been altered or tampered with in any way. Please see website for terms and conditions.



### WARNING: Risk of electric shock!

#### Isolate the mains power before proceeding.

- Turn off the mains power before performing inspections, installation, or removal
- Verify that the supply voltage is correct by comparing it with the luminaire label information
- It is the installers responsibility to ensure installation is suitable for the total load of the luminaire(s). The supply cable, fuses/circuit breakers must be correctly rated for the electrical load and considering for any transient inrush currents that may occur.
- Do not perform insulation strength or resistance tests on installed luminaire(s) connected

#### Wiring instructions for units equipped an with EMERGENCY function:

Emergency lighting luminaries must be installed and maintained in accordance with the emergency lighting standard BS 5266-1

- For the emergency unit to work correctly, please ensure that an uninterrupted permanent live feed is present and is connected directly to the 'Permanent Live' terminal of the mains terminal block. Please ensure there are no switches, PIRs etc within the permanent live feed, constant switching of the emergency pack could result in premature battery failure.
- Following power up the green LED indicator should illuminate to indicate charging. If power to the unit is disrupted or isolated, the unit indicating green LED will switch off, triggering the emergency LEDs to illuminate.
- When self-test mode is selected, 24hrs from connection to mains power, a 3hrs duration test will be performed automatically.

#### Installation Procedure:

1. Unscrew and remove the cover.
2. Open geartray and drill the required mounting holes in the base and mount into desired location using suitable fixing method.
3. Wire the incoming supply.
4. Connect the battery.
5. Select your Maintained (PM1) / Non-Maintained operation (PM2).
6. Select your required function, Self-test (EL-T) / Manual test (EL).
7. Refit geartray and diffuser.
8. Reconnect mains supply.

#### Emergency Indication:

	Colour	LED Indication	Status
	Green	Permanent Green	Normal Function
	Green	Fast Flashing Green (0.1 sec on, 0.1 sec off)	Function Test In Progress
	Green	Slow Flashing Green (1 sec on, 1 sec off)	Duration Test In Progress
	Red	Permanent Red	Load Failure
	Red	Slow Flashing Red (1 sec on, 1 sec off)	Battery Failure

To reset unit after failure, press and hold button located next to battery terminal for 5 seconds.

1.

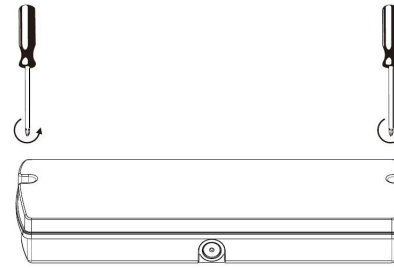

2.

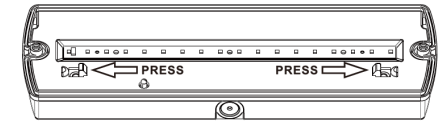

3.

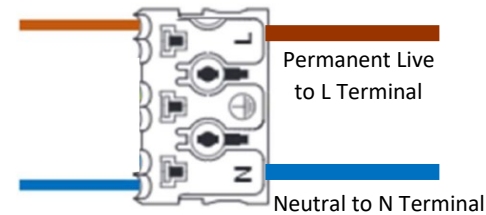

4.

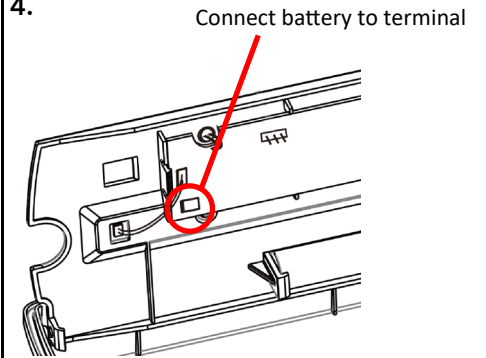

5.

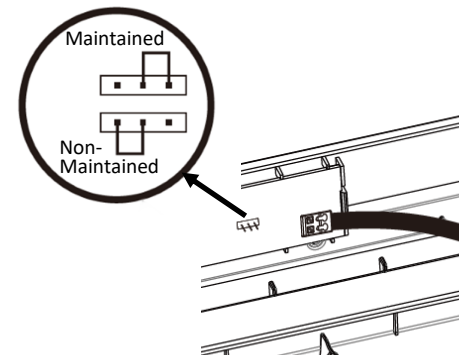

6.

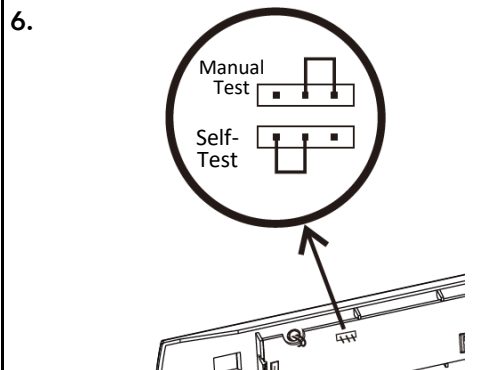

7.

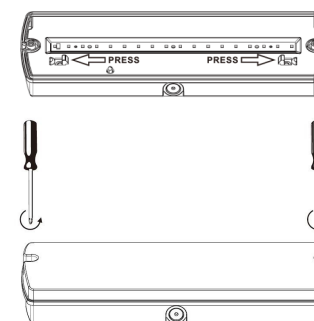

8.

